

Telenco OTB+ - Optical Transition Box (CSP)



The Telenco OTB+ is a compact, wall-mounted fibre access enclosure that enables both Blown Fibre and fixed cable access to the customer premises. Optimised for FTTH and in-building deployments, it supports all standard methods, flexible fibre management in a durable, modular housing. A unique two-layer management system separates Network and Access work areas, each providing splice, patch and slack-storage capability to streamline installation and maintenance. For a neat, professional finish on customer properties, the termination box interfaces directly with Telenco’s standard capping and hardware.

FEATURES & BENEFITS

- Compact footprint with high splice storage capacity (up to 24 splices)
- Flexible modular design for customised configurations
- Easy, time and cost effective installation and maintenance
- Secure cable management and protection
- UK standard compliance and capping compatibility
- Available in colors suited for UK homes and premises
- UV stabilised for outdoor durability
- Up to 8mm drop cable entry point

TECHNICAL SPECIFICATION

Number of Splices		24F
Capacity	SC	2 SC Mating
	LC	4 LC Mating
Mounted Method		Wall mounted
Splice Method		Shrink and Crimp Splice
Cable Loaded		Cable Mid-Span
Material		Material PC+ABS UL-94-V0
Colour		Black, Grey, Brown Option.
IP Rating		IP 55

INTERNAL COMPONENTS

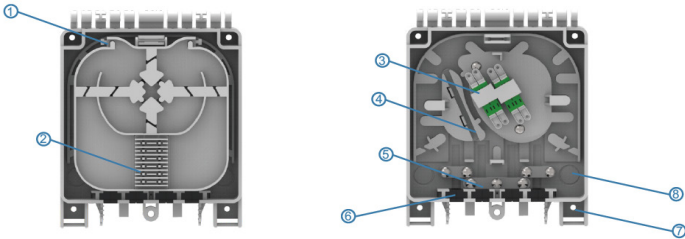

- ① Tie Fixation

③ Adapter Clip (2*SCSX or 2* LCDX)

⑤)Cable Clip

⑦ Mounting Hole
- ② 24F Splice Clip

④ PLC Splitter Area 1x4 or 1x8

⑥ Cable Entry

⑧ Rear Entry

DROP CABLE ENTRY



Name	Type:A	Type:B
Number of drop cable exit points	1	2
Cable diameter	3-7mm	3-7m

MECHANICAL DRAWING (UNIT:MM)

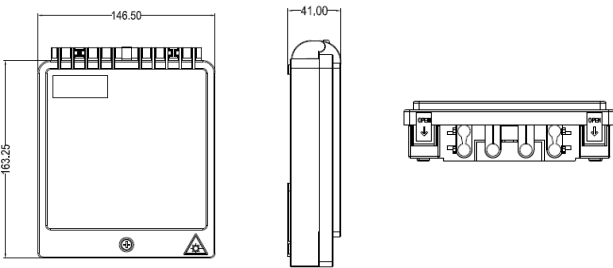

ADDITIONAL ACCESSORIES



BT Capping 25 BT Connector Bend No.4 BT Cover 101A